

Modular Cooking - Grandis

Gas - Range

NGTR 12-90 GR



Due to continuous technical development, the image shown may not represent the latest design of the unit.

DESCRIPTION

Modular gas open burner with 900 mm depth and 6 hobs, 3 sets of 5.5 kW and 10 kW cast iron burners. Equipped with open cabinet.

Usable for boiling, steaming, frying, braising, simmering and steam frying.

Made of AISI 304 with 2 mm top thickness, manual ignited, fully welded basin for hygiene purpose, galvanized coated cast iron burner.

OTHER AVAILABLE MODELS

- NGR 12-90 GR
- NGR 8-90 GR
- NGTR 8-90 GR
- NGR 8-90 DFX EOY GR
- NGTR 4-90 GR
- NGR 12-90 DFX EOY GR

MAIN FEATURES

- Powered with a 6 hobs, 3 sets of 5.5 kW and 10 kW cast iron open burner.
- Fully-welded basin for hygiene.
- Cast iron pot holder with long fin to support various size of pot or pan.
- Equipped with flame failure device.
- The optimized pan diameter for 5.5 kW burner is between 240-460 mm.
- The optimized pan diameter for 10 kW burner is between 300-500 mm.

CONSTRUCTION

- External construction entirely with AISI 304.
- Top panel with 2 mm thickness. Orbital surface finishing: resistant toward scratches.
- Front panel is constructed of 1 mm AISI 304 with satin surface finish.
- Side panel is constructed of 0.8 mm AISI 304 with satin surface finish.
- Adjustable +/- 25 mm AISI leg.
- Cabinet executed with H2 radius.
- Connector between Grandis product on the front and the back.

INCLUDED ACCESSORIES

- G20 Conversion Kit
- Cast iron pot holder.

OPTIONAL ACCESSORIES

- Stainless steel pot holder GR.
- Joint clip GR.
- Swing door 12-90 GR.

FRONT

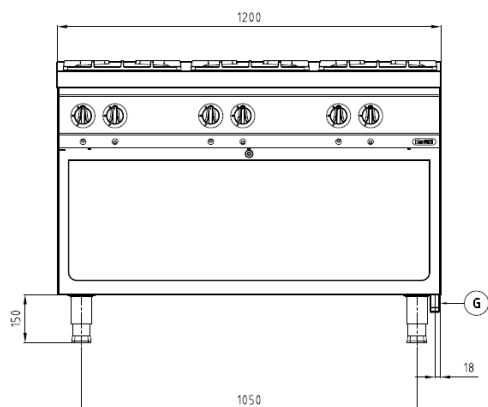

TOP

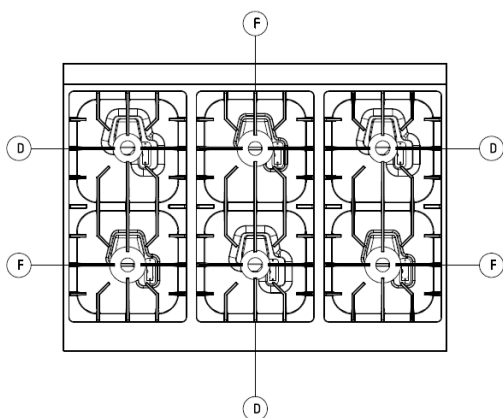

SIDE

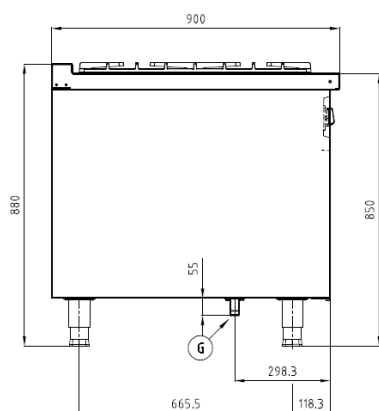

*Overall dimension in mm

TECHNICAL DATA

External Dimensions

Width : 1200 mm
Depth : 900 mm
Height : 850/910 mm

Cooking Surface

Cooking zones : 3 x 370 x 725 mm

Gas Power Rating

Heat input total : LPG/Natural Gas 46.5 kW
No. of burners : 6
Control type : High - low power control
Gas type options : LPG G30, G31
Natural Gas G20, G25

Connections

Gas : DN 20 (3/4")
Water : N/A
Drain : N/A

Heat & Steam Emissions

Direct heat emission : 11.63 kW
Latent heat emission : 4.65 kW
Steam emission : 6.84 kg/h

PACKAGING DATA

Width : 1230 mm
Depth : 930 mm
Height : 1030 mm
Volume : 1.18 m³

WEIGHT

Net Weight : 102 kg
Gross Weight : 143 kg

PT. NAYATI INDONESIA

www.nayati.com

Nayati reserves the right to make product alterations and or price adjustments at any time and can not be held responsible for any printing errors or omissions.

11/11/2021