

Modular Cooking - Meritus

Gas - Fryer

NGF 14 2T (ME)



Due to continuous technical development, the image shown may not represent the latest design of the unit.

DESCRIPTION

Modular gas fryer with 750 mm depth and double tank with oil capacity of 2 x 14 liters, powered with two sets of 10.5 kW AISI tubular burner on each tank. Equipped with swing door.

Usable for deep frying.

Made of AISI 304 with 1.5 mm top thickness, manually ignited, includes dedicated cold zone to prolong usable oil lifetime and better fried products. Includes fryer basket, tank cover, crumb filter and oil drain kit.

OTHER AVAILABLE MODELS

- NGF 4-75 (ME)

MAIN FEATURES

- Powered with 2 x 10.5 kW stainless-steel burners.
- Oil capacity of 2 x 14 liters
- Frying basket, tank cover, oil drain kit, and crumb filter included.
- Fully welded fryer tank.
- Drain valve with 1" on the front surface provided
- Thermal-cut off when overheated.

CONSTRUCTION

- External construction entirely with AISI 304.
- Top panel with 1.5 mm thickness. Orbital surface finishing: resistant toward scratches.
- Front panel is constructed of 0.8 mm AISI 304 with satin surface finish.
- Side panel is constructed of 0.8 mm AISI 304 with satin surface finish.
- Adjustable +/- 25 mm AISI leg.
- Nayati connection system between Meritus products on the front panels, cabinets, and splashbacks.
- Cabinet executed with H2 radius.
- Deep drawn front panel to minimize liquid penetration to the internal part.
- Gasket protection behind the knobs to prevent water to seeping in, prolonging main heating regulation parts.

INCLUDED ACCESSORIES

- G20 Conversion Kit
- Fryer basket(2 pcs.).
- Crumb filter.
- Oil drain pipe and container.
- Fryer tank lid.

OPTIONAL ACCESSORIES

- Joint clip ME.

FRONT

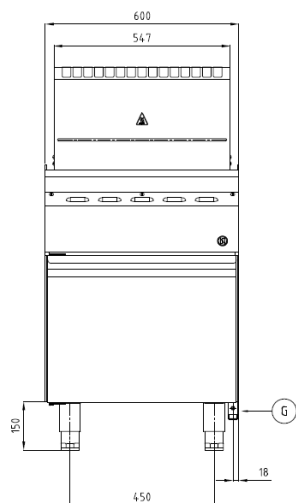

TOP

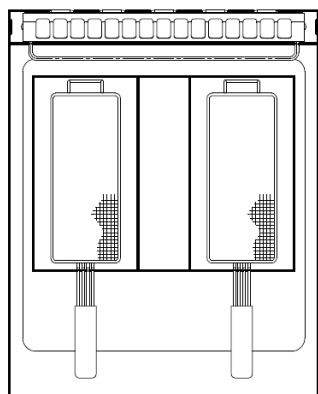

SIDE

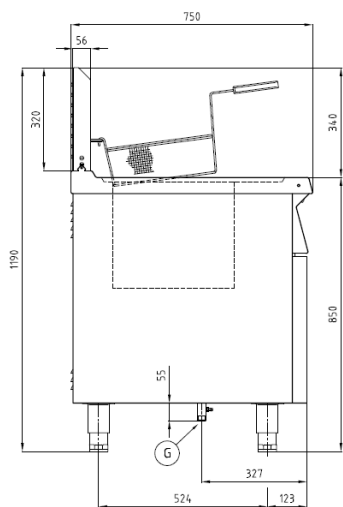

*Overall dimension in mm

TECHNICAL DATA

External Dimensions

Width : 600 mm
Depth : 750 mm
Height : 850/1085 mm

Cooking Surface

Cooking zones : 2 x 14 liters, 2 x 203 x 378 mm

Gas Power Rating

Heat input total : LPG/Natural Gas 21 kW
No. of burners : 4
Control type : Modulating temperature control
Gas type options : LPG G30, G31
Natural Gas G20, G25

Connections

Gas : DN 15 (1/2")
Water : N/A
Drain : DN 25 (1")

Heat & Steam Emissions

Direct heat emission : 1.89 kW
Latent heat emission : 14.7 kW
Steam emission : 21.63 kg/h

PACKAGING DATA

Width : 630 mm
Depth : 780 mm
Height : 1205 mm
Volume : 0.59 m³

WEIGHT

Net Weight : 70 kg
Gross Weight : 86 kg